

REMOVAL

1. REMOVE STEERING WHEEL PAD

NOTICE:

- If the airbag connector is disconnected with the ignition switch at ON or ACC, DTCs will be recorded.
- Never use airbag parts from another vehicle. When replacing parts, replace with new ones.

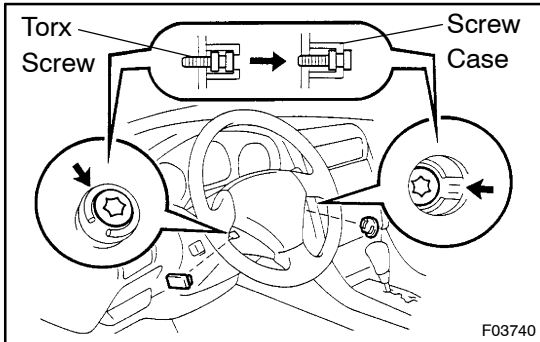

- Place the front wheels facing straight ahead.
- Remove the steering wheel lower No.2 and No.3 covers.
- Using a torx socket wrench, loosen the 2 torx screws.

HINT:

Loosen the 2 screws until the groove along the screw circumference catches on the screw case.

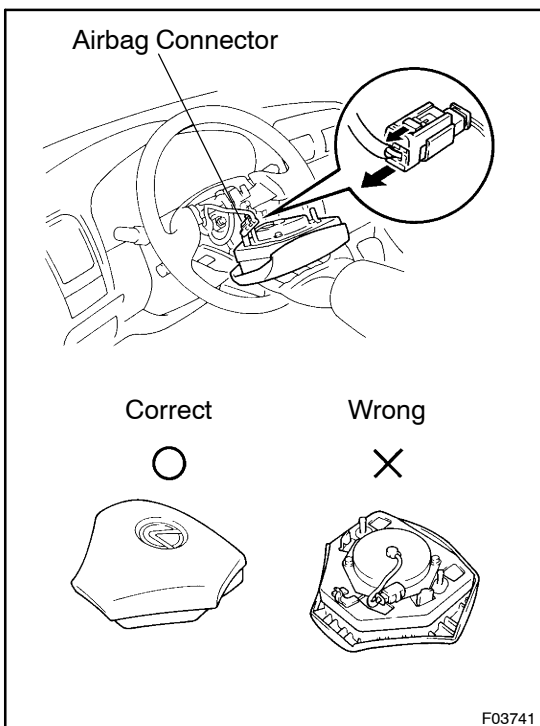

- Pull the pad out from the steering wheel and disconnect the airbag connector.

CAUTION:

- When storing the wheel pad, keep the upper surface of the pad facing upward.
- Never disassemble the wheel pad.

NOTICE:

When removing the wheel pad, take care not to pull the airbag wire harness.

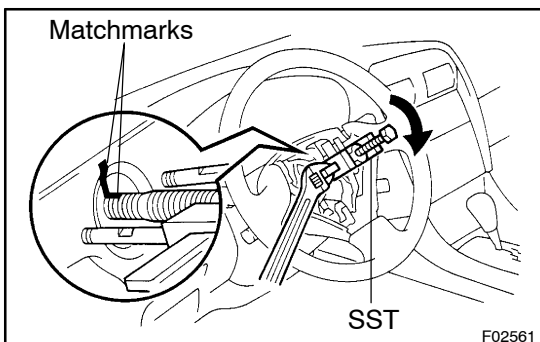

2. REMOVE STEERING WHEEL

- Disconnect the connector.
- Remove the steering wheel set nut.
- Place matchmarks on the steering wheel and main shaft assembly.
- Using SST, remove the wheel.

SST 09950-50010 (09951-05010, 09952-05010, 09953-05020, 09954-05020)

3. REMOVE UPPER AND LOWER COLUMN COVERS

Remove the 3 screws.

4. REMOVE COMBINATION SWITCH WITH SPIRAL CABLE

- (a) Disconnect the 4 connectors.
- (b) Disconnect the airbag connector.
- (c) Remove the 3 screws.

5. REMOVE SPIRAL CABLE

(See page BE-35)

NOTICE:

Do not disassemble the cable or apply oil to it.

6. REMOVE NO.1 UNDER COVER

- (a) Remove the 3 screws.
- (b) Remove the DLC3.
- (c) Disconnect the connectors.

7. REMOVE FINISH PLATE AND END PAD**8. REMOVE NO.1 SAFETY PAD**

- (a) Remove the 2 screws and disconnect the hood lock release lever from the panel.
- (b) Remove 4 pad set bolts and screw.

9. REMOVE HEATER TO REGISTER DUCT NO.7

Remove the nut.

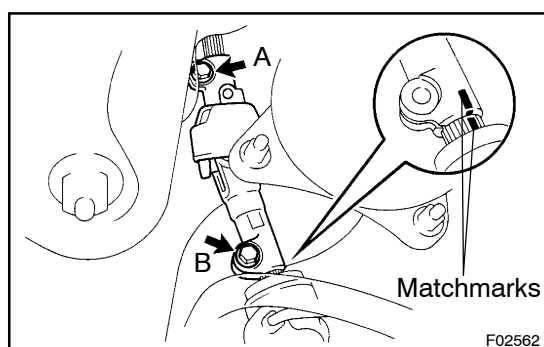
**10. DISCONNECT INTERMEDIATE SHAFT ASSEMBLY**

- (a) Place matchmarks on the intermediate shaft and control valve shaft.
- (b) Loosen the bolt A and remove the bolt B.

11. REMOVE STEERING COLUMN ASSEMBLY

- (a) Disconnect the connectors.
- (b) Remove the brake pedal return spring.

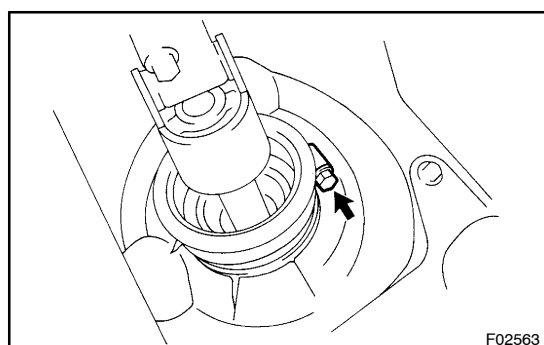

- (c) Loosen the hole cover clamp.
- (d) Remove the 4 column assembly set nuts.

12. REMOVE INTERMEDIATE SHAFT ASSEMBLY

Remove the bolt A.

13. REMOVE DUST COVER